

### Fire Resistant Revision Covers

## SECURUS® RV

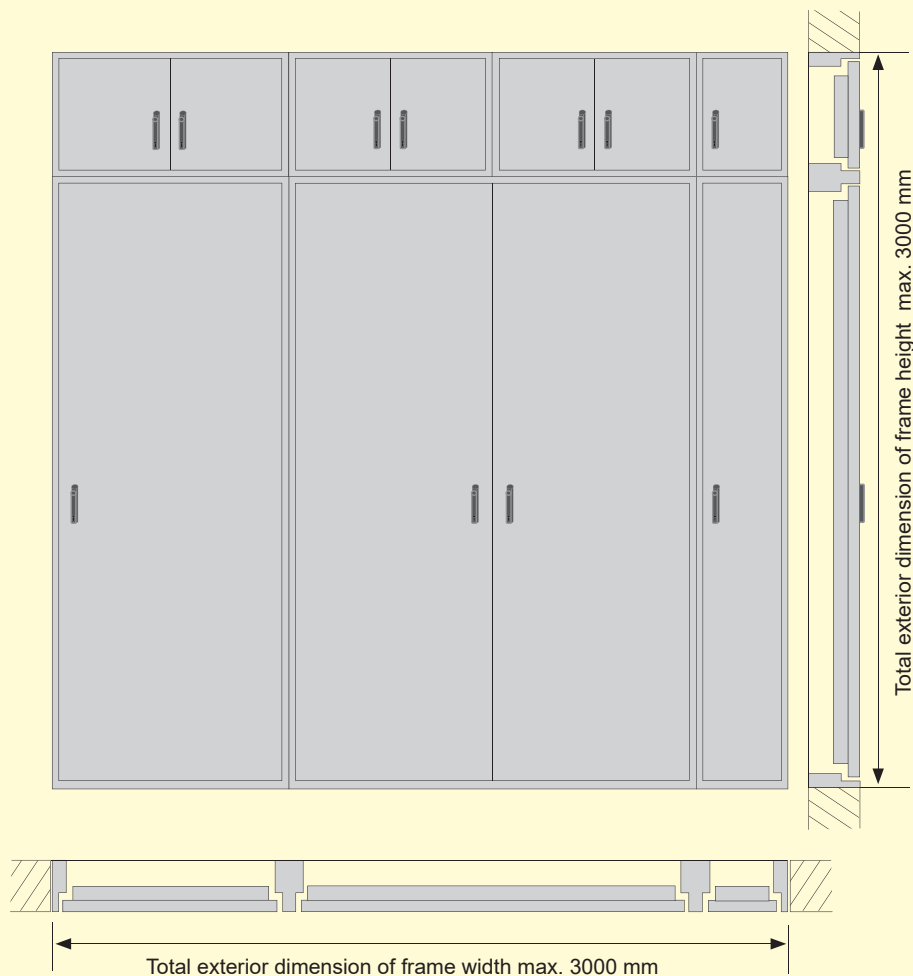

Example of a possible arrangement

### SECURUS STW

Revision Cover Wall System, consisting of several revision covers SECURUS RV-W-UPT90 aligned to and connected with each other. Within the given minimum and maximum dimensions you can combine single and double leaf executions in different sizes with each other:

- Max. five revision covers (single or double leaf) can be arranged horizontally.
- Max. two revision covers (single or double leaf) can be arranged vertically.

The system is meant for the installation in a (shaft) wall opening and is also available as a version which directly lines up with the floor.

### Applicability / Wall Installation

Acc. to aBG No. Z-6.56-2433 Fire resistance duration 90 min. (fireproof)

Fire test with on-sided fire attack („fire from the inside“) according to DIN 4102-2: 1977-09 („fire behaviour of building materials and structural elements“)

For a detailed description of the single elements this system is based of, please refer to our leaflet „SECURUS RV-UPT90“.

The system is meant to be installed in large wall openings in fire resistant installation walls made of masonry or (reinforced) concrete, with at least 100 mm thickness. The maximal height of the installation shaft wall may amount to max. 4000 mm.

If installed and in closed state, it reliably prevents fire and smoke passing through from the inside of the shaft to the outside over a period of at least 90 minutes, which makes it perfectly applicable to be used in escape and emergency routes.

### Horizontal Connections

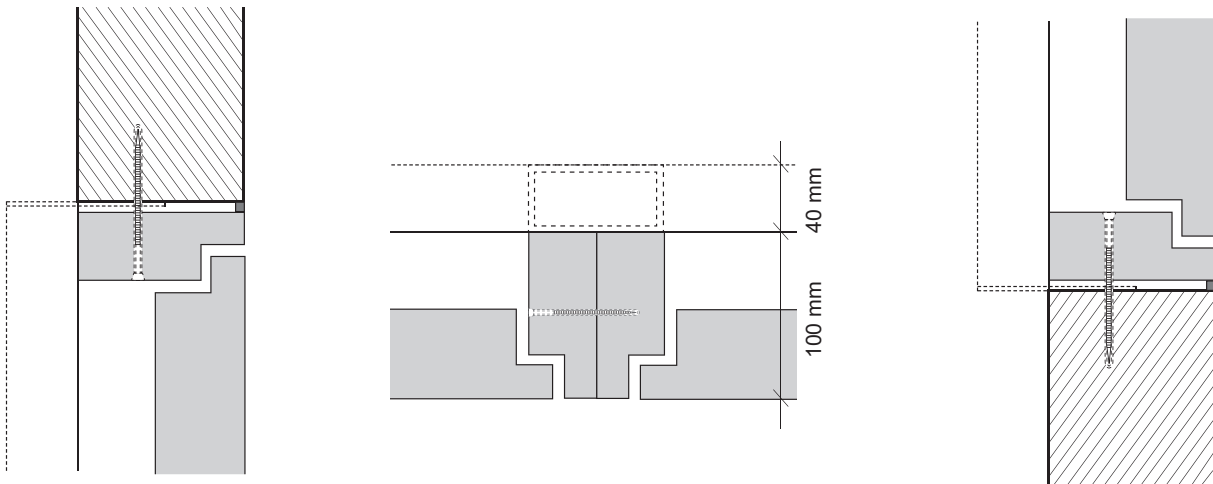

### Vertical Connections

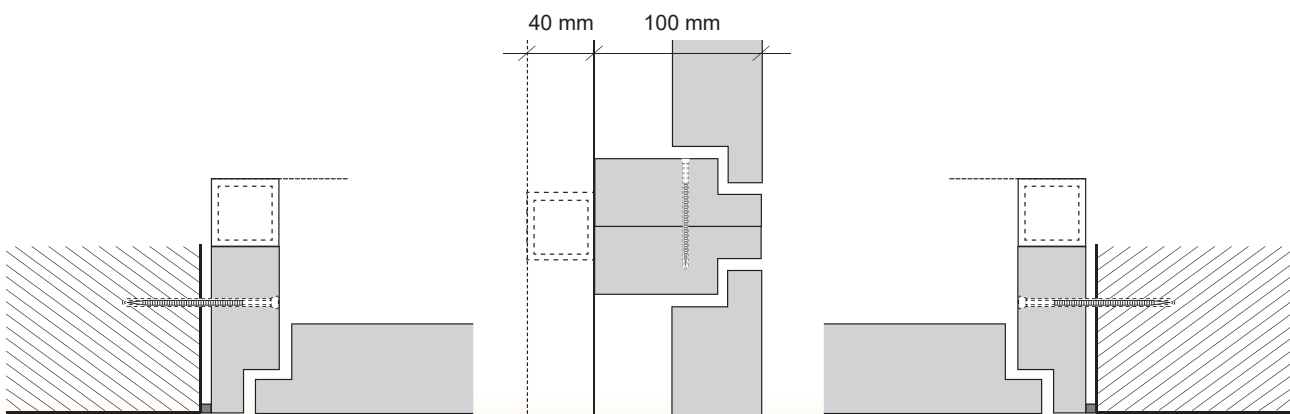

Subject to alterations.  
We do not assure liability for printing or typographical errors.  
Please see our commercial terms and conditions

BS-030STW-1123e © EAS